

NOTES:

- \* WHEN USING CASING BEAD WITHOUT WEEPHOLES, WATER RESISTANT BARRIER(S) SHALL LAP ATTACHMENT FLANGE OF FLASHING AND NOT CASING.
- 1. Z-CHANNEL FURRING IS RECOMMENDED FOR RIGID FOAM THICKNESSES GREATER THAN 2"

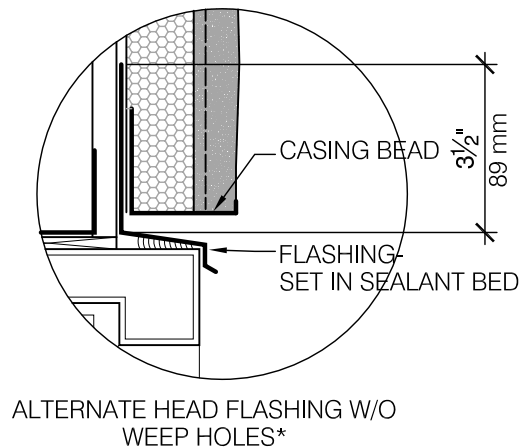

STOREFRONT WINDOW HEAD- GUIDE DETAIL  
 PWA-104 (REV. 12/10)